

RoHS COMPLIANT

| CUSTOMER DRAWING | | | |
|------------------|----------|-----------------------------------|------------|
| REV. | ECO. NO. | DESCRIPTION | DATE |
| G | ES160712 | ADD the first pin mark | 2016.06.03 |
| H | ES170901 | ADD plating "U" & "W" | 2017.09.01 |
| I | ES180805 | Change Layout:00.90→01.0 +0/-0.10 | 2018.08.08 |
| J | ES200706 | B-5 area:Delete 5.00;Add 4.30 | 2020.07.27 |

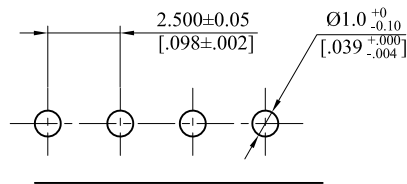
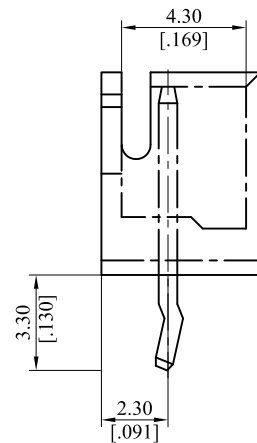
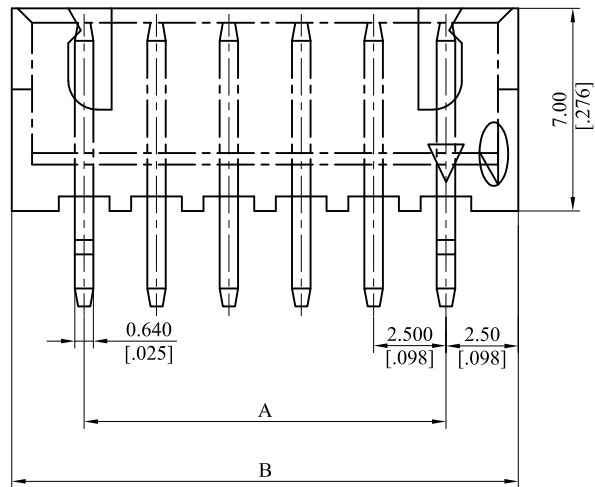
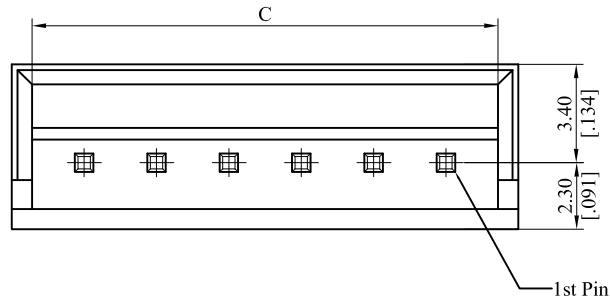

Recommended PCB Hole Pattern

Note:

Material:
Insulator:Thermoplastic,UL94V-0
Contact: Brass

General part number:

2521P**V*0*
1 2 3

1.No. of circuits

2.Plating

0=Tin plated 120μ" min. over 30μ" min. nickel overall
U=Gold flash over 30μ" min. Nickel underplating overall

3.Coloour

1=Black 3=Red 7=Blue 0=White

A=2.50(.098")xNo. of spces

B=A+5.00(.197")

C=A+3.60(.142")

Circuits with The position of the kink

| circuits | the position of the kink | circuits | the position of the kink |
|----------|--------------------------|----------|--------------------------|
| 2P | 1st 2nd | 12P | 1st 12nd |
| 3P | 1st 3rd | 13P | 1st 13rd |
| 4P | 1st 4th | 14P | 1st 14th |
| 5P | 1st 5th | 15P | 1st 15th |
| 6P | 1st 6th | 16P | 1st 16th |
| 7P | 1st 7th | 17P | 1st 17th |
| 8P | 1st 8th | 18P | 1st 18th |
| 9P | 1st 9th | 19P | 1st 19th |
| 10P | 1st 10th | 20P | 1st 20th |
| 11P | 1st 11st | | |

| TOLERANCE UNLESS OTHERWISE SPECIFIED | | | LEOCO CORPORATION http://www.leoco.com.tw | | |
|--------------------------------------|--------|--------|---|------------|-----------------|
| mm [inch] | mm | inch | APPROVED BY: | DATE: | TITLE: |
| 1 PLACE | ± 0.30 | ± -- | Chard | 2020.07.27 | 2.50Pitch Wafer |
| 2 PLACES | ± 0.20 | ± .012 | Spring | 2020.07.27 | |
| 3 PLACES | ± 0.10 | ± .008 | Angel | 2020.07.27 | PART NO.: |
| 4 PLACES | ± -- | ± .004 | | | 2521P**V*0* |
| ANGULAR ±1° | | | SIZE: | SCALE: | DRAWING NO.: |
| | | | A3 | 1:1 | 252109S |
| | | | | | REV.: |
| | | | | | J |
| | | | | | SHEET: |
| | | | | | 1 OF 1 |