

REV.	ECO. NO.	DESCRIPTION	DATE
I	ES180805	Change Layout:Ø0.90→Ø1.0 +0/-0.10	2018.08.08
J	ES200706	B-5 area:Delete 5.00;Add 4.30	2020.07.27
K	ES230611	B-6 area:ADD Specification	2023.07.05
L	ES241201	B-2&B-3:Add gap in appearance	2024.12.04

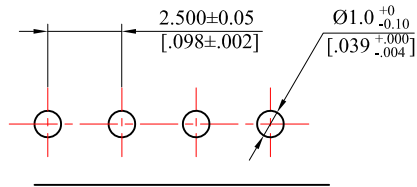
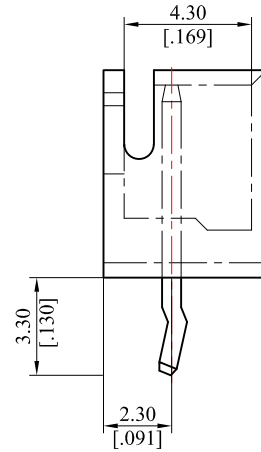
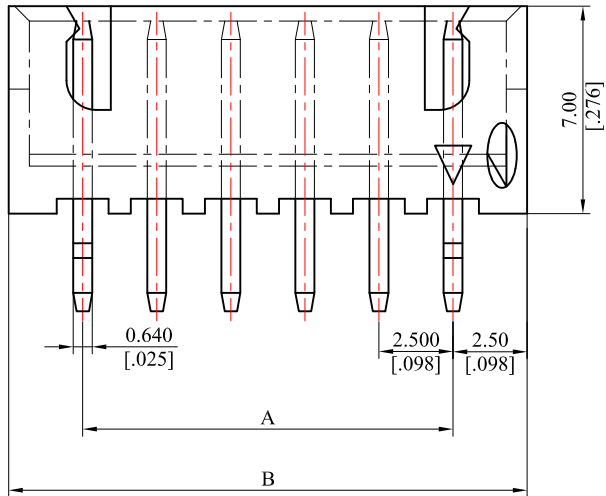
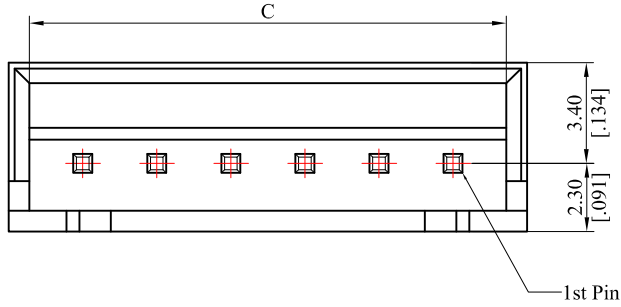

Recommended PCB Hole Pattern

Note:

Material:
 Insulator: Thermoplastic, UL94V-0
 Contact: Brass
 Specification:
 Current rating: 3.0A AC/DC
 Voltage rating: 250V AC/DC
 Temperature rating: -40°C~105°C

General part number:

2521P** V * 0 *
 1 2 3

1.No. of circuits

2.Plating

0= Tin plated 120µ" min. over 30µ" min. nickel overall
 U= Gold flash over 30µ" min. Nickel underplating overall

3.Colour

1=Black 3=Red 7=Blue 0=White

A=2.50(.098")xNo.of spcscs

B=A+5.00(.197")

C=A+3.60(.142")

Circuits with The position of the kink

circuits	the position of the kink		circuits	the position of the kink	
2P	1st	2nd	12P	1st	12nd
3P	1st	3rd	13P	1st	13rd
4P	1st	4th	14P	1st	14th
5P	1st	5th	15P	1st	15th
6P	1st	6th	16P	1st	16th
7P	1st	7th	17P	1st	17th
8P	1st	8th	18P	1st	18th
9P	1st	9th	19P	1st	19th
10P	1st	10th	20P	1st	20th
11P	1st	11st			

TOLERANCE UNLESS OTHERWISE SPECIFIED			LEOCO CORPORATION http://www.leoco.com.tw		
mm [inch]	mm	inch	APPROVED BY:	DATE:	TITLE:
1 PLACE	± 0.30	± --	Chard	2024.12.10	2.50Pitch Wafer
2 PLACES	± 0.20	± .012	CHECKED BY:	DATE:	
3 PLACES	± 0.10	± .008	Angel	2024.12.10	PART NO.: 2521P**V*0*
4 PLACES	± --	± .004	Aimee	2024.12.04	
ANGULAR ±1°			SIZE: A3	SCALE: 1:1	DRAWING NO.: 252109S
					REV.: L
					SHEET: 1 OF 1