

*** 1086 Series ***

Material :

* Insulator : Thermoplastic UL 94V-0

* Contact : Brass

* Plating : Tin Plated 120u" min. Over 30u" min . Nickel Overall.

Ordering information:

1086P**0001
1 2

1.No.of circuits

2.Base color:

01=black

RoHS COMPLIANT

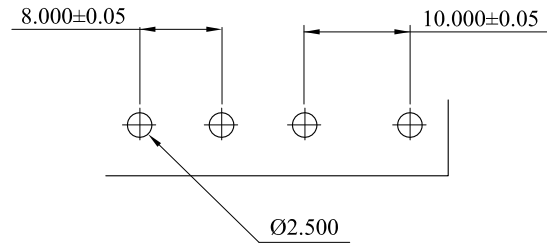

RECOMMENDED HOLE PATTERN

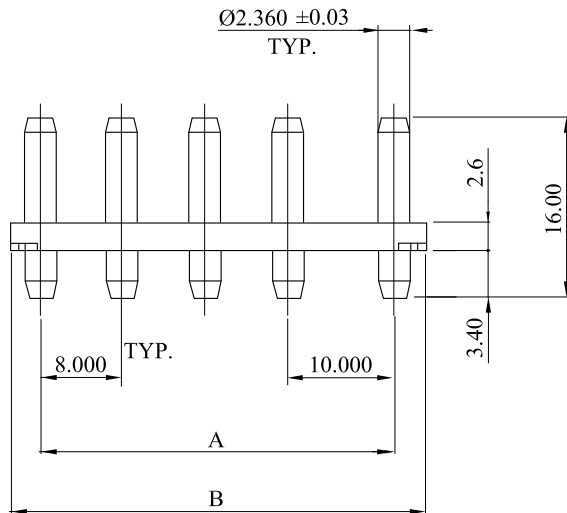

CIRCUITS	DIMENSION	
	A	B
2	10.00±0.20	16.00±0.30
3	18.00±0.20	24.00±0.30
4	26.00±0.30	32.00±0.40
5	34.00±0.30	40.00±0.40
6	42.00±0.30	48.00±0.40

G	ES120924			LEOCO CORPORATION GENERAL TOLERANCES: (UNLESS SPECIFIED) <table border="1"> <thead> <tr> <th></th> <th>mm</th> <th>inch</th> </tr> </thead> <tbody> <tr> <td>1 PLACE</td> <td>± 0.30</td> <td>± --</td> </tr> <tr> <td>2 PLACES</td> <td>± 0.20</td> <td>± .012</td> </tr> <tr> <td>3 PLACES</td> <td>± 0.10</td> <td>± .008</td> </tr> <tr> <td>4 PLACES</td> <td>± --</td> <td>± .004</td> </tr> </tbody> </table> ANGULAR ± (1°)		mm	inch	1 PLACE	± 0.30	± --	2 PLACES	± 0.20	± .012	3 PLACES	± 0.10	± .008	4 PLACES	± --	± .004	APPROVED: CHARD	PART NO.: 1086P**0001			
	mm	inch																						
1 PLACE	± 0.30	± --																						
2 PLACES	± 0.20	± .012																						
3 PLACES	± 0.10	± .008																						
4 PLACES	± --	± .004																						
F	ES101209			DATE:	TITLE: HEADER																			
E	ES070803			CHECKED: ANGEL	DRAWING NO.: 108604S																			
D	ES031004			DATE:	DATE: 12.09.26																			
C	ES000313			DRAWN: RICE	UNITS	SCALE	SIZE	SHEET	REV.															
REV.	ECO. NO.	CHG.	APP.			mm inch	2:1	A4	1/1	G														