

*** 1276 Series ***

Material:

Insulator: UL94V-0 PA6T+30%G.F

Contact: Brass

Ordering Information :

1276 S $\frac{**}{1} \frac{*}{2}$ 000

1. No. of circuits

2. Plating :

T= Tin plated 120u"min. over 30u"min. nickel overall

U= Gold flash over 30u"min. nickel overall

W= 15u"min. gold over 30u"min. nickel overall

Z= 30u"min. gold over 30u"min. nickel overall

RoHS COMPLIANT

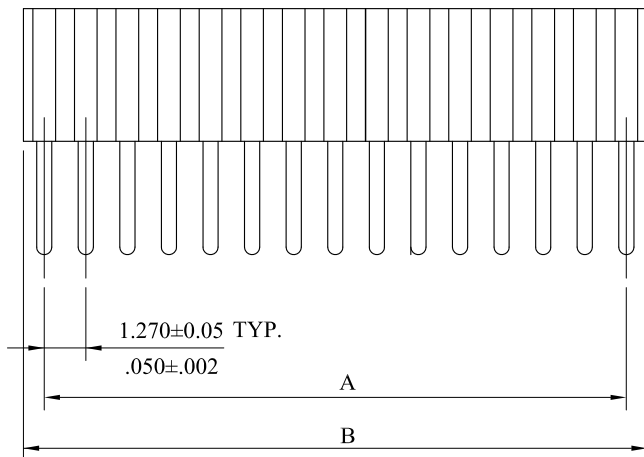
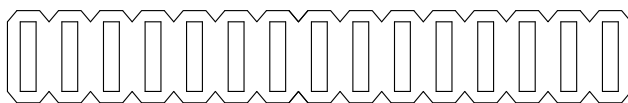

Dim.A = 1.27mm * No. of spaces
Dim.B = Dim.A + 1.27mm + 0.50 ± 0.30

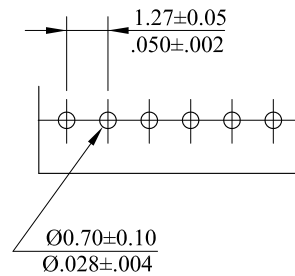
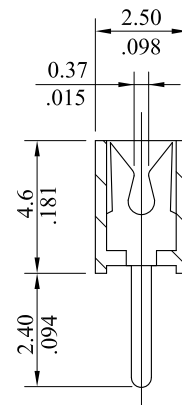

RECOMMENDED HOLE PATTERN

				LEOCO CORPORATION		APPROVED:		PART NO.:					
				GENERAL TOLERANCES: (UNLESS SPECIFIED)		DATE:		1276S***000					
						CHECKED:		TITLE:					
						DATE:		CONNECTOR					
						DRAWN:		DRAWING NO.:					
						DATE:		127601S					
								UNITS		SCALE	SIZE	SHEET	REV.
				ANGULAR ± (1°)				$\frac{\text{mm}}{\text{inch}}$		4:1	A4	1/1	D
REV.	ECO. NO.	CHG.	APP.										