

**Material:**

\* Insulator: Nylon66, UL94V-0  
 \* Contact: Phosphor Bronze

**Ordering Information:**

1376S \*\*\* \* 00  
 1 2 3

RoHS COMPLIANT

1. No. of circuits. (Available in 6 through 100)

2. Plating:

T= Tin plated 120μ" min. 30μ"min. nickel overall

U= Gold flash over 30μ"min. nickel overall

W= 15μ"min. gold plated over 30μ"min. nickel overall

Z= 30μ"min. gold plated over 30μ"min. nickel overall

3. Special option

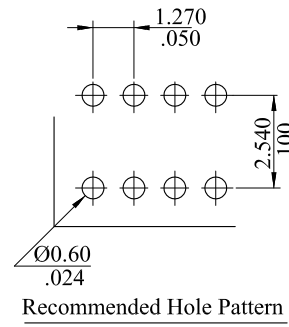
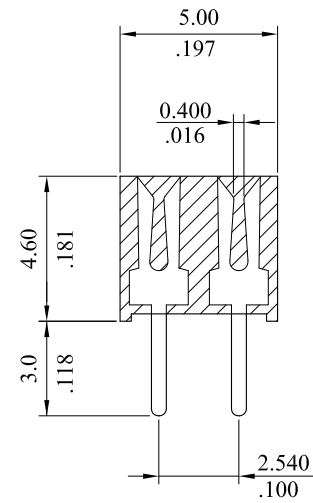
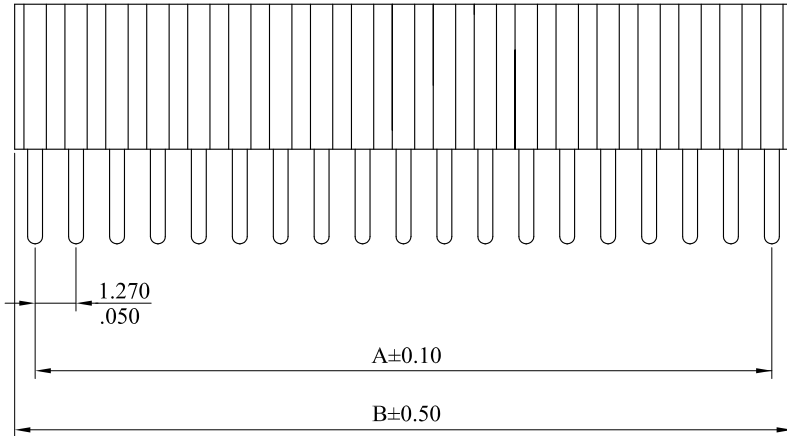
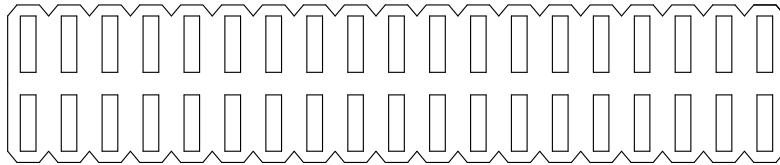

Dim.A= 1.270mm(.050") \* No. of Spaces

Dim.B= Dim.A + 1.270mm(.050")

				<b>LEOCO CORPORATION</b>	APPROVED:		PART NO.:				
					DATE:		1376S****00				
				GENERAL TOLERANCES: (UNLESS SPECIFIED)		CHECKED:		TITLE:			
C	ES101222					DATE:		1.27mm(.050") Pitch Dual Row PCB Connector			
						DRAWN:		DRAWING NO.:			
B	E990124					DATE:		137601S			
						UNITS		SCALE	SIZE	SHEET	REV.
A	DWG REL							4:1	A4	1/1	C
REV.	ECO. NO.	CHG.	APP.	ANGULAR ± ( 1° )							