

*** 2046 H Series ***

Material :

* Insulator : Nylon 6T+30% Glass Fiber UL 94V-0

* Contact : Brass

A=2.00(.079)x No.of spaces

B=A+9.00(.366)

C=A+7.80(.307)

Ordering Information :

2046P ** H * T 0

1 2

1. No. of circuits

2. Plating :

T=Tin plated 120u" min. over 30u"min. nickel overall

U=Gold flash over 30u"min. nickel overall

RoHS COMPLIANT

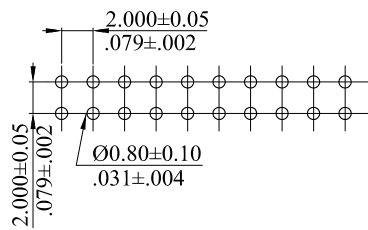
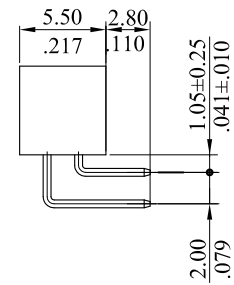
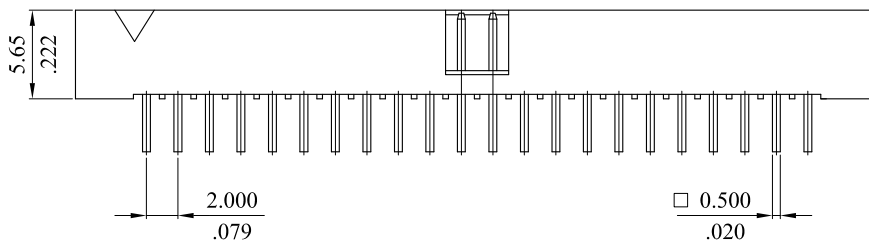
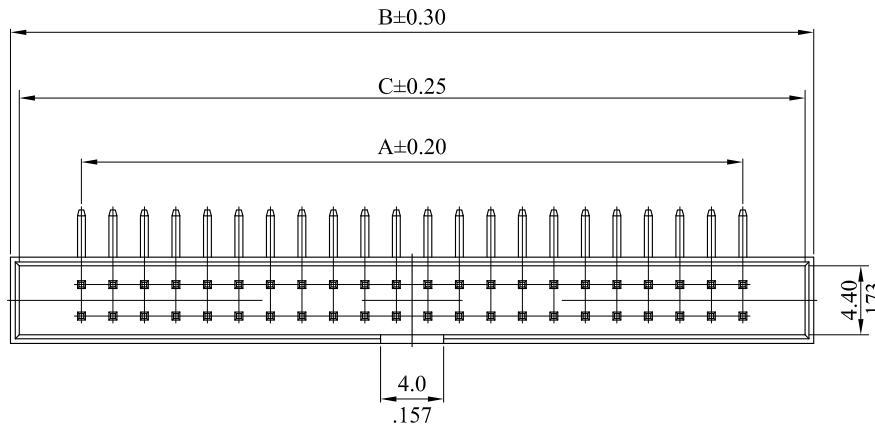

RECOMMENDED HOLE PATTERN

				LEOCO CORPORATION		APPROVED: CHARD		PART NO.: 2046P**H*T0				
				GENERAL TOLERANCES: (UNLESS SPECIFIED)		DATE:		TITLE: Box Header				
C	ES120320					CHECKED: SMILE						
B	ES101222					DATE:		DRAWING NO.: 204611S				
A	DWG REL					DRAWN: ANGEL						
REV.	ECO. NO.	CHG.	APP.			DATE: 12.03.19						
				ANGULAR ± (1°)				UNITS	SCALE	SIZE	SHEET	REV.
								mm inch	2:1	A4	1/1	C