

CUSTOMER DRAWING				
REV.	ECO. NO.	DESCRIPTION	DATE	
A	DWG REL			
B	ES070256			
C	ES101238			
D	ES170524	Material: PBT-High Temperature Thermoplastic		
E	ES220603	Add plating option "B"	2022.06.14	

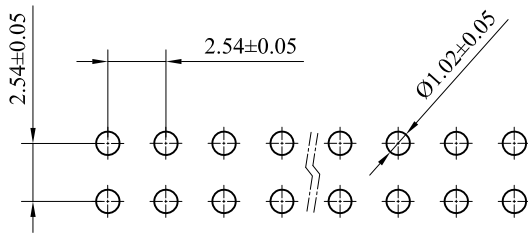
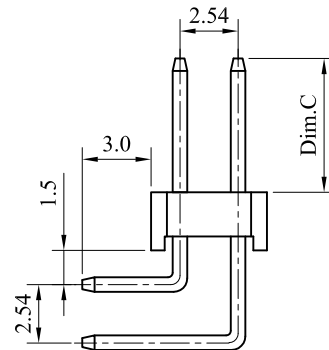
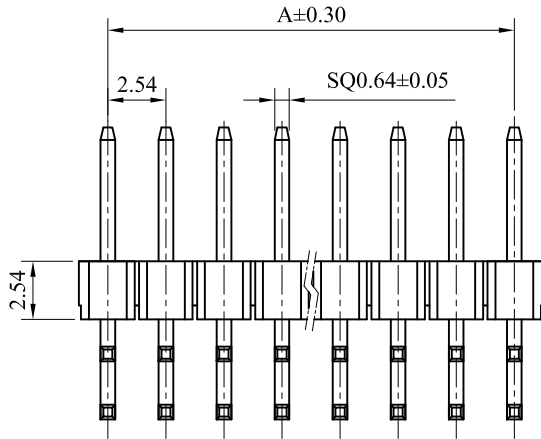
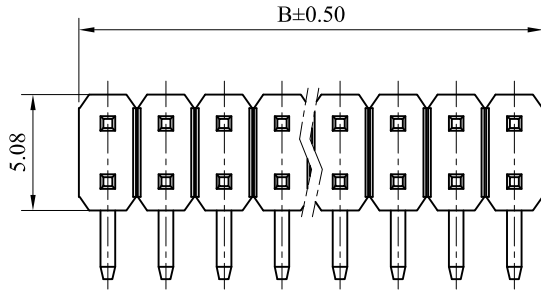

Recommended P.C.B Layout

Material:  
 Insulator: High Temperature Thermoplastic, UL94V-0,Black  
 Contact: Brass

General Part Number:  
 2559P \*\* \* \* 00  
 1 2 3

1.No.of circuits(02~80)

2.Plating

- T= Tin plated 120u"min. over 30u" min. Nickel underplating overall
- M= Matte Tin plated 80u"min. over 30u" min. Nickel underplating overall
- U= Gold flash over 30u" min. Nickel underplating overall
- W= 15u" min. Gold over 30u" min. Nickel underplating overall
- Z= 30u" min. Gold over 30u" min. Nickel underplating overall
- F= Selective Gold flash on contact area over 30u" min. Nickel underplating overall, Tin plated on solder tails
- J= 15u" min. Selective Gold on contact area over 30u" min. Nickel underplating overall, Tin plated on solder tails
- K= 30u" min. Selective Gold on contact area over 30u" min. Nickel underplating overall, Tin plated on solder tails
- B= Selective 10u" min, Gold on contact area over Gold flash overall

3.Pin Length options:

- A: Dim.C=6.26mm      B: Dim.C=7.26mm
- C: Dim.C=8.86mm      D: Dim.C=5.86mm

A=2.54mm \*No. of spaces  
 B=A+2.54mm

TOLERANCE UNLESS OTHERWISE SPECIFIED			LEOCO CORPORATION <a href="http://www.leoco.com.tw">http://www.leoco.com.tw</a>		
mm	mm	inch	APPROVED BY: Chard	DATE: 2022.06.15	TITLE: 2.54 Pitch Pin Header
1 PLACE	± 0.30	± ---	CHECKED BY: Angel	DATE: 2022.06.15	PART NO.: 2559P****00
2 PLACES	± 0.20	± --	DRAWN BY: Janey	DATE: 2022.06.15	
3 PLACES	± 0.10	± -	SIZE: A3	SCALE: 1:1	
4 PLACES	± ---	± -	ANGULAR ±1°		
			DRAWING NO.:	REV.:	SHEET:
			255901S	E	1 OF 1