

RoHS COMPLIANT

CUSTOMER DRAWING		
REV.	ECO. NO.	DESCRIPTION
A	DWG. REL.	APPROVED
B	ES050423	
C	ES060336	
D	ES071009	
E	ES101238	
F	ES161214	Area 1-B: 2.8→2.5 Material: PBT→PA6T
G	ES170210	Adjust layout

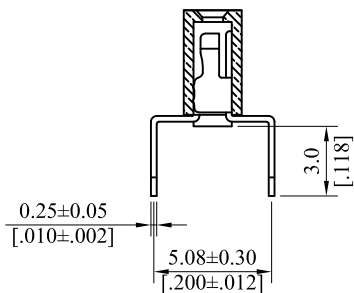
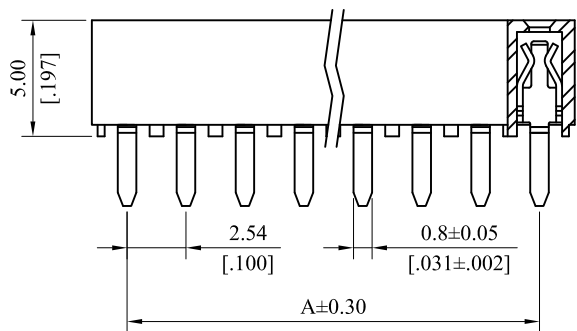
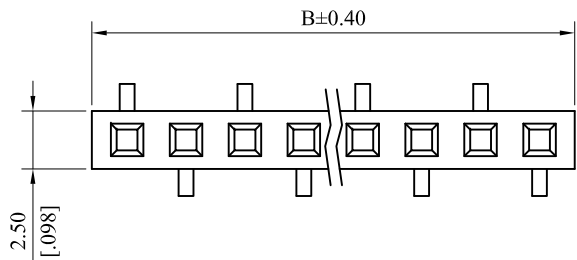

Material:  
Insulator: PA6T, UL94V-0, Black  
Contact: Phosphor bronze

General Part Number:

2611S \*\* \* 00B  
1 2

1.No.of circuits(1~40)

2.Plating

- M=Matte Tin plated 80u"min. over 30u" min. Nickel underplating overall
- U=Gold flash over 30u" min. Nickel underplating overall
- W=15u" min. Gold over 30u" min. Nickel underplating overall
- Z=30u" min. Gold over 30u" min. Nickel underplating overall
- J=15μ"min. Selective Gold on contact area over 30μ" min. Nickel underplating overall, Tin plated on solder tails
- K=30μ"min. Selective Gold on contact area over 30μ" min. Nickel underplating overall, Tin plated on solder tails

A=2.54mm \*No.of spaces

B=A+3.04mm

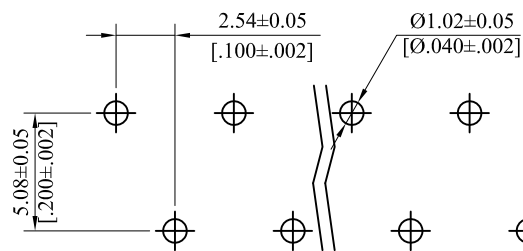

Recommended PCB Layout

TOLERANCE UNLESS OTHERWISE SPECIFIED			LEOCO CORPORATION <a href="http://www.leoco.com.tw">http://www.leoco.com.tw</a>		
mm	mm	inch	APPROVED BY:	DATE:	TITLE:
[inch]			Chard	2017.02.21	2.54 Pitch Socket
			CHECKED BY:	DATE:	
1 PLACE	± 0.30	± ---	Angel	2017.02.21	PART NO.: 2611S***00B
2 PLACES	± 0.20	± .012	DRAWN BY:	DATE:	
3 PLACES	± 0.10	± .008	Spring	2017.02.21	
4 PLACES	± ---	± .004	SIZE:	SCALE:	
ANGULAR ±1°			A3	1:1	DRAWING NO.: 261101S
					REV.: G
					SHEET: 1 OF 1